

Storage 60 bay

Supermicro X10DRL-i

A storage server, also known as a file server, is a type of server used to store, secure, and manage data and applications. This server is primarily built for storing and accessing data through the internet or over a shared network

This is TrueNAS Open Storage. More than a traditional “Network Attached Storage”, TrueNAS is Unified Storage that integrates seamlessly into any environment with a variety of file, block, or object access protocols.

TrueNAS SCALE includes the ability to scale-out storage with capacities of up to hundreds of Petabytes. Just like TrueNAS CORE, TrueNAS SCALE is designed to be the most secure and efficient solution to managing and sharing data over a network, from smaller home networks “scaled” up to massive business environments.

Features:

- Base Operating System: FreeBSD or Linux
- Storage Services:
 - File: SMB v1/v2/v3, NFS v3/v4, FTP, WebDAV, rsync
 - Block: iSCSI with VAAI support
 - Object: S3-Compliant API, Minio single node, Cloud Sync
- System Management: SNMP, Syslog, REST API, GUI
- Directory Services: Active Directory, Google 2FA, Kerberos, LDAP, Local users and groups
- Supported Clouds: iX-Storj, Amazon S3, Ms Azure, Google Cloud, BackBlaze B2



①. Switch Components

②. HDD Tray

Specifications:

CPU	: Intel Xeon 8C/16T 2.6-3.4GHz
Architecture	: CPU 64-bit
Memory	: DDR4 ECC 32GB
Drive bay	: 60 bays 6Gb/s Expander
HDD Type	: SAS/SATA 3.5” or 2.5”
Form Factor	: 6U / 65CM
Network	: Dual GbE LAN and KVM over LAN
Storage	: SSD 240GB boot operating system
Power Supply	: 1200watt Single PSU
Form Factor	: 6U Rackmount
Dimension	: 650mm(D) x 437.5mm(W) x 265mm(H)

Optional:

OS system	: TrueNAS - Network Attached Storage
Warranty	: Extend 3 years

Applications:

A NAS system is a storage device connected to a network that allows storage and retrieval of data from a centralized location for authorized network users and heterogeneous clients. NAS systems are flexible and scale-out, meaning that as you need additional storage, you can add on to what you have.

NAS is purposed for Analytics, Backup & Archival, Cloud, Data Mobility, File Sharing, Media Creation, Surveillance, Virtualization.

Distributed by.

TrueNAS – Mitrasarana Telematika

Office: Arden Miller clock tower – Jl. Pejaten Raya No.12a Jakarta Selatan 12510
Direct Calls / WhatsApp: +62 821 146 11732



Specification

Component	Description
Dimension	650mm(D) x 437.5mm(W) x 265mm(H)
Material	1.0mm SGCC Zinc-Coated Steel
HDD Bay	60x3.5" hot-swap Sata/Sas drive bays, 2x2.5" drive bays
Cooling Fan	6pcs 12038 hot-swap fans
HDD Tray	Anti-EMI design, compatible with 2.5"/3.5" HDD
Suitable M/B	MAX support to 13.68" x 13"(EE-ATX) motherboard
HDD Backplane	6Gb/s backplane(Optional 12Gb/s), compatible with SATA/SAS HDD, with temperature control, SGPIO, Hard disk time sharing start
Suitable PSU	CRPS power supply
System Control	Power LED, Reset, Power SW, HDD LED, NIC LED x 2, UID LED, UID SW, OH/Fan Fail LED, PWR Fail LED, USB3.0 x 2
Applications	Cloud storage, IPFS, Security monitoring, etc



①. Switch Components ②. HDD Tray

Model Dimensions

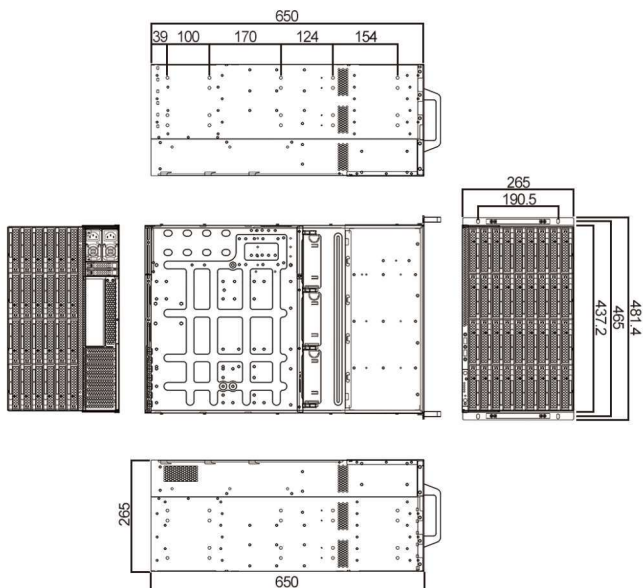

①. CRPS Power Supply ③. Hot-swap Fan Module
②. 2*2.5" HDD/SSD

Detail Description

